

Патроны для концевых фрез с боковым зажимом

DIN69871-EM

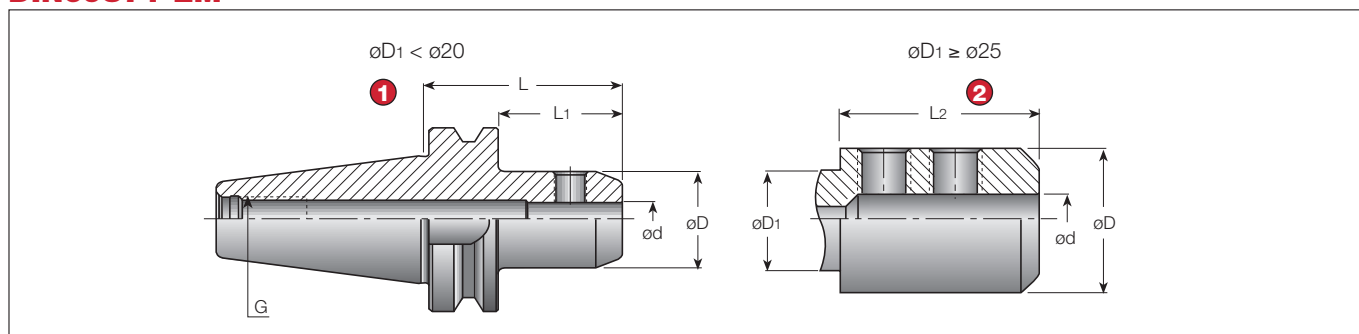

1 DIN69871 Form A/B

2 DIN6359

DIN1835 Form B (Weldon type)

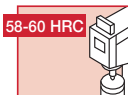
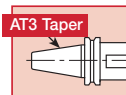
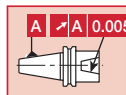

DIN69871-EM Патроны для концевых фрез (тип Weldon)

| Кат. № | Размеры (mm) | | | | | | |
|---------------------|--------------|----------|------------|-----|-------|----|-----|
| | ϕd | ϕD | ϕD_1 | L | L1 | L2 | G |
| DIN6987130EM6X50 | 6 | 25 | - | 50 | 30.9 | - | M12 |
| DIN6987130EM8X50 | 8 | 28 | - | 50 | 30.9 | - | M12 |
| DIN6987130EM10X50 | 10 | 35 | - | 50 | 30.9 | - | M12 |
| DIN6987130EM14X63 | 14 | 44 | - | 63 | 43.9 | - | M12 |
| DIN6987130EM16X63 | 16 | 48 | - | 63 | 43.9 | - | M12 |
| DIN6987130EM18X72 | 18 | 50 | - | 72 | 52.9 | - | M12 |
| DIN6987130EM20X72 | 20 | 52 | - | 72 | 52.9 | - | M12 |
| DIN6987140EM6X50 | 6 | 25 | - | 50 | 30.9 | - | M16 |
| DIN6987140EM6X50B | 6 | 25 | - | 50 | 30.9 | - | M16 |
| DIN6987140EM8X50 | 8 | 28 | - | 50 | 30.9 | - | M16 |
| DIN6987140EM8X50B | 8 | 28 | - | 50 | 30.9 | - | M16 |
| DIN6987140EM10X50 | 10 | 35 | - | 50 | 30.9 | - | M16 |
| DIN6987140EM12X50 | 12 | 42 | - | 50 | 30.9 | - | M16 |
| DIN6987140EM12X50B | 12 | 42 | - | 50 | 30.9 | - | M16 |
| DIN6987140EM14X63 | 14 | 44 | - | 63 | 43.9 | - | M16 |
| DIN6987140EM16X63 | 16 | 48 | - | 63 | 43.9 | - | M16 |
| DIN6987140EM16X63B | 16 | 48 | - | 63 | 43.9 | - | M16 |
| DIN6987140EM18X63 | 18 | 50 | - | 63 | 43.9 | - | M16 |
| DIN6987140EM18X63B | 18 | 50 | - | 63 | 43.9 | - | M16 |
| DIN6987140EM20X63 | 20 | 52 | - | 63 | 43.9 | - | M16 |
| DIN6987140EM20X63B | 20 | 52 | - | 63 | 43.9 | - | M16 |
| DIN6987140EM25X100 | 25 | 65 | 49.0 | 100 | 80.9 | 65 | M16 |
| DIN6987140EM25X100B | 25 | 65 | 49.0 | 100 | 80.9 | 65 | M16 |
| DIN6987140EM32X100 | 32 | 71 | 49.0 | 100 | 80.9 | 65 | M16 |
| DIN6987140EM32X100B | 32 | 71 | 49.0 | 100 | 80.9 | 65 | M16 |
| DIN6987150EM6X63 | 6 | 25 | - | 63 | 43.9 | - | M24 |
| DIN6987150EM8X63 | 8 | 28 | - | 63 | 43.9 | - | M24 |
| DIN6987150EM10X63 | 10 | 35 | - | 63 | 43.9 | - | M24 |
| DIN6987150EM10X63B | 10 | 35 | - | 63 | 43.9 | - | M24 |
| DIN6987150EM12X63 | 12 | 42 | - | 63 | 43.9 | - | M24 |
| DIN6987150EM12X63B | 12 | 42 | - | 63 | 43.9 | - | M24 |
| DIN6987150EM14X63 | 14 | 44 | - | 63 | 43.9 | - | M24 |
| DIN6987150EM14X63B | 14 | 44 | - | 63 | 43.9 | - | M24 |
| DIN6987150EM16X63 | 16 | 48 | - | 63 | 43.9 | - | M24 |
| DIN6987150EM16X63B | 16 | 48 | - | 63 | 43.9 | - | M24 |
| DIN6987150EM18X63 | 18 | 50 | - | 63 | 43.9 | - | M24 |
| DIN6987150EM18X63B | 18 | 50 | - | 63 | 43.9 | - | M24 |
| DIN6987150EM20X63 | 20 | 52 | - | 63 | 43.9 | - | M24 |
| DIN6987150EM20X63B | 20 | 52 | - | 63 | 43.9 | - | M24 |
| DIN6987150EM25X80 | 25 | 65 | - | 80 | 60.9 | - | M24 |
| DIN6987150EM25X80B | 25 | 65 | - | 80 | 60.9 | - | M24 |
| DIN6987150EM32X100 | 32 | 72 | - | 100 | 80.9 | - | M24 |
| DIN6987150EM32X100B | 32 | 72 | - | 100 | 80.9 | - | M24 |
| DIN6987150EM40X100 | 40 | 90 | 79.9 | 100 | 80.9 | 43 | M24 |
| DIN6987150EM40X100B | 40 | 90 | 79.9 | 100 | 80.9 | 43 | M24 |
| DIN6987150EM50X125 | 50 | 98 | 79.9 | 125 | 105.9 | 90 | M24 |
| DIN6987150EM50X125B | 50 | 98 | 79.9 | 125 | 105.9 | 90 | M24 |

Добавьте В для подачи СОЖ через фланец.